

Welcome to the revolution elite

iNfeel Installation Guide



1.-What is iNfeel?	Page 3
2.-Tools	Page 4
3.-Installation on walls (smooth surface)	Page 5
4.-Installation in furniture (curved surface)	Page 9
5.-Lap joint	Page 12
6.-Outer and inner edges	Page 13
7.-Installation on doors	Page 15
8.-Cleaning and maintenance	Page 16
9.-iNfeel removal	Page 17
10.-Technical assistance	Page 18

Legend

iNfeel

ARCHITECTURAL FINISH FILM

What is iNfeel?

iNfeel is a laminated PVC, high resistance multilayer, self-adhesive, suitable to be applied on any interior surface as long as it is dry, clean and smooth. Covers furniture, cabinets, doors, walls, kitchens, bathrooms, elevators, everything will change appearance quickly.

Its water-repellent condition and its fire-retardant quality (Certification B-S1-D0) make it suitable for installation on walls or surfaces exposed to water and/or with risk of circumstantial exposure to heat or fire.



Tools



Meter



Plastic Spatula



Blade



Air hot gun



Gloves



Primer



Rulers

Installation on walls

Vertical wall – smooth surface

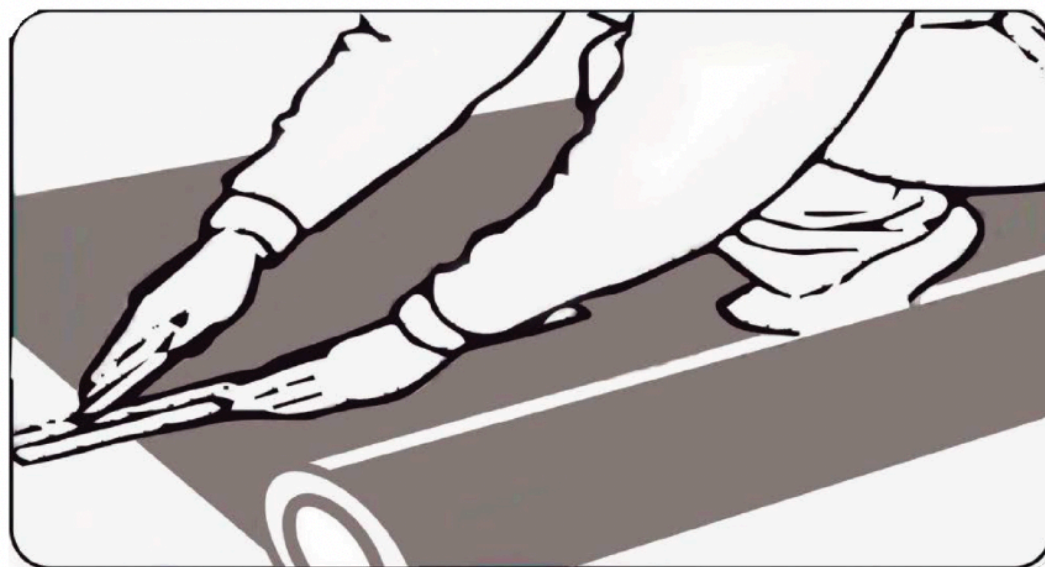

STEP 1

Check that the wall is clean and smooth, if there are concavities we will fill and then sand on plasterboard or walls that have not been painted for years, apply a layer of primer.

Measure the height and width of the surface to be covered. Cut the necessary amount of iNfeel adding 4 cm to the total height as a margin to correct possible unevenness.

Installation on walls

Vertical wall – smooth surface

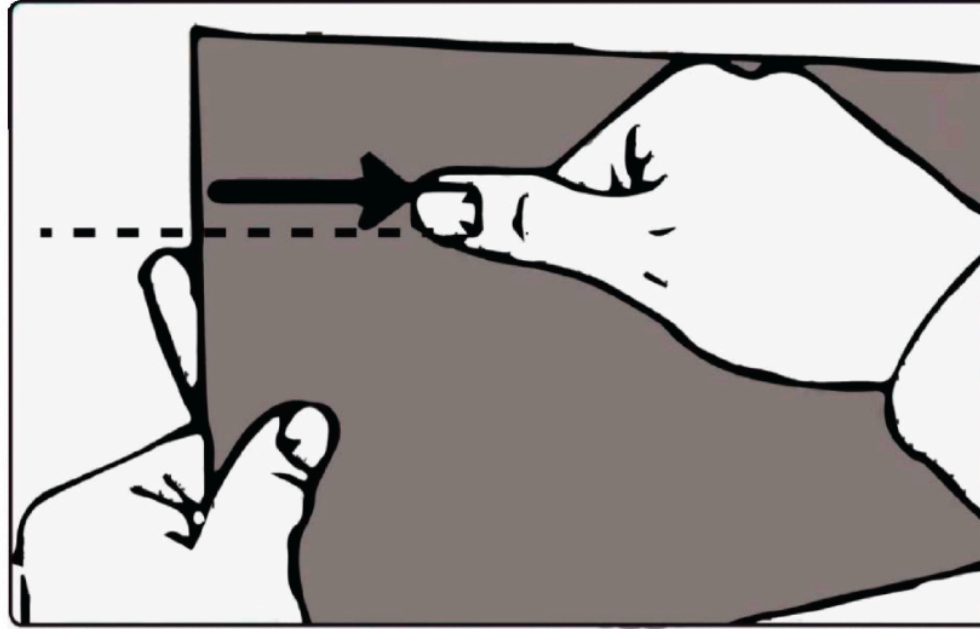

STEP 2

To carry out a correct installation, it is recommended to take several reference points along the surface to be covered. It is recommended to take into account the entrance to the room or space for start placing from the opposite point and thus not visualize the overlaps when entering.

Remove the backing from the adhesive, about 5 cm. Place the INfeel sheet taking into account the marked points and exerting a slight pressure to be able to replace it in case of error.

Installation on walls

Vertical wall – smooth surface

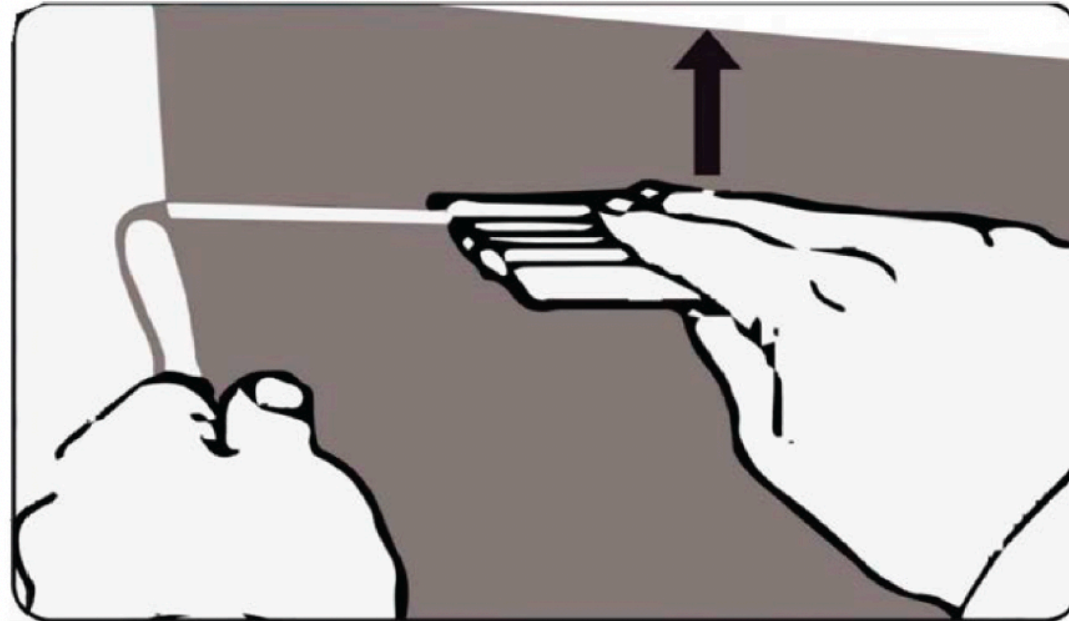

STEP 3

Once the sheet has been positioned correctly, start to apply pressure to fix it, always from the centre towards the ends.

It is recommended to place the plastic spatula at an angle of 45° with the installation surface.

Installation on walls

Vertical wall – smooth surface

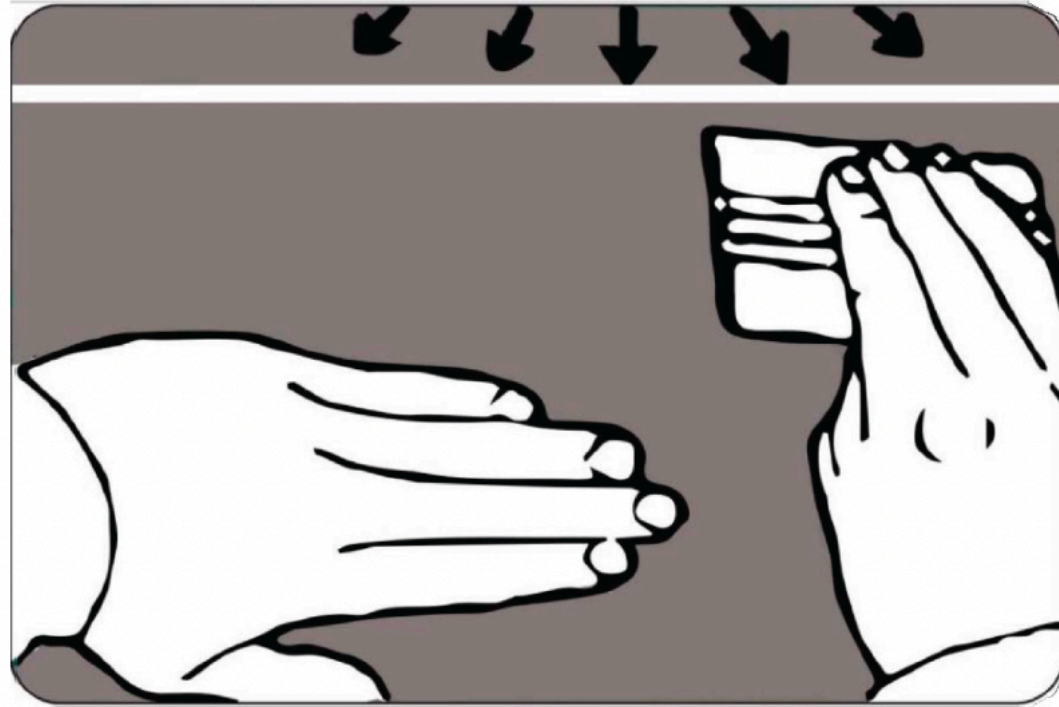

STEP 4

Remove the adhesive protector gradually as you apply the material. Apply additional pressure on the edges, corners, and joints to ensure perfect adherence.

STEP 5

Once INfeel sheet is placed, go over the edges and corners applying pressure again with the plastic spatula. Remove any excess material, make a single and precise cut with the cutter using the plastic edge of the spatula as a guide.

Furniture installation

Vertical wall – curved surface

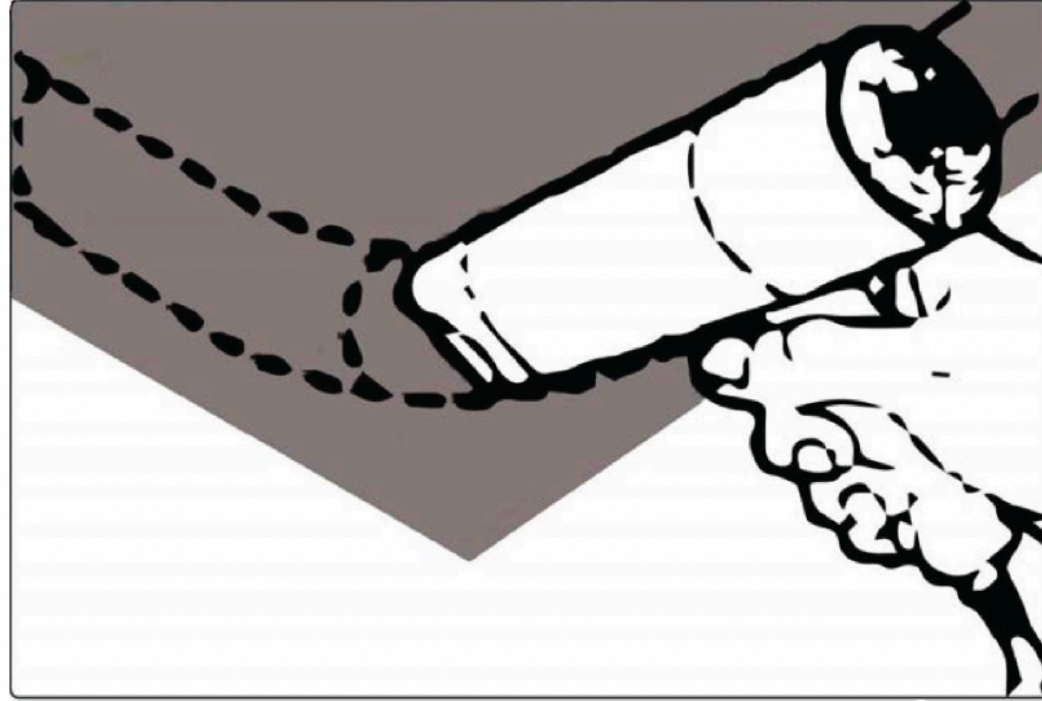

STEP 1

Measure the surface to be covered. Cut the INfeel sheet adding a margin of about 10 cm around the whole perimeter.

STEP 2

Apply heat evenly over the entire curved surface making constant movements. It is important to maintain a minimum distance of about 10 cm and ensure that the heat is apply evenly.

Furniture installation

Vertical wall – curved surface

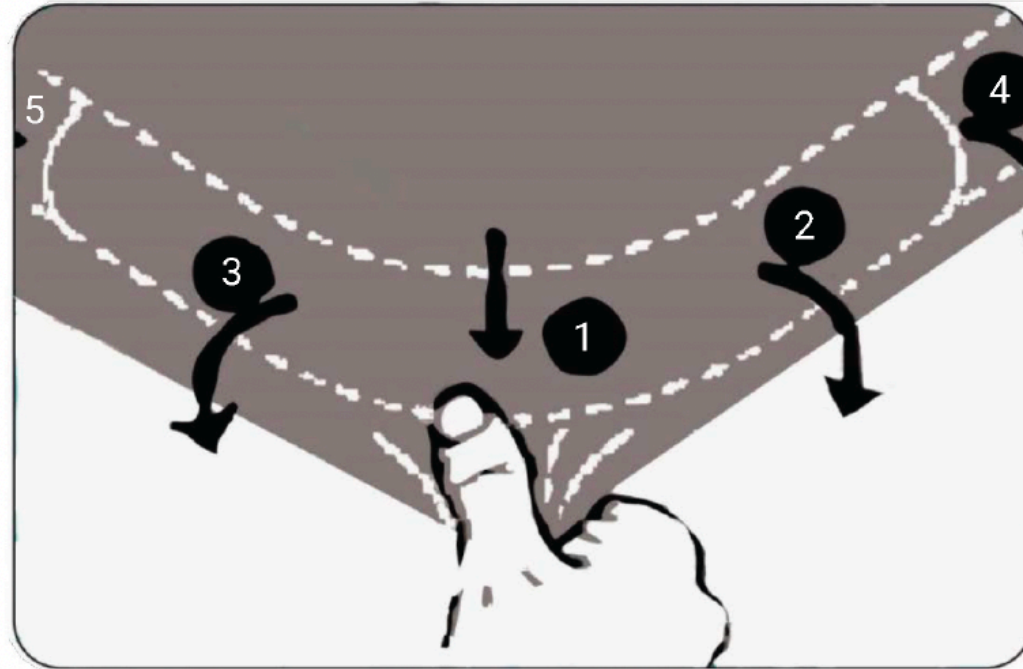

STEP 3

Start to apply tension in zone 1 and gradually continue with zones 2, 3, 4 and 5, respecting the order. It is important that the tension is applied continuously and progressively to avoid distortions due to excessive tension and creation of wrinkles.

Furniture installation

Vertical wall – curved surface

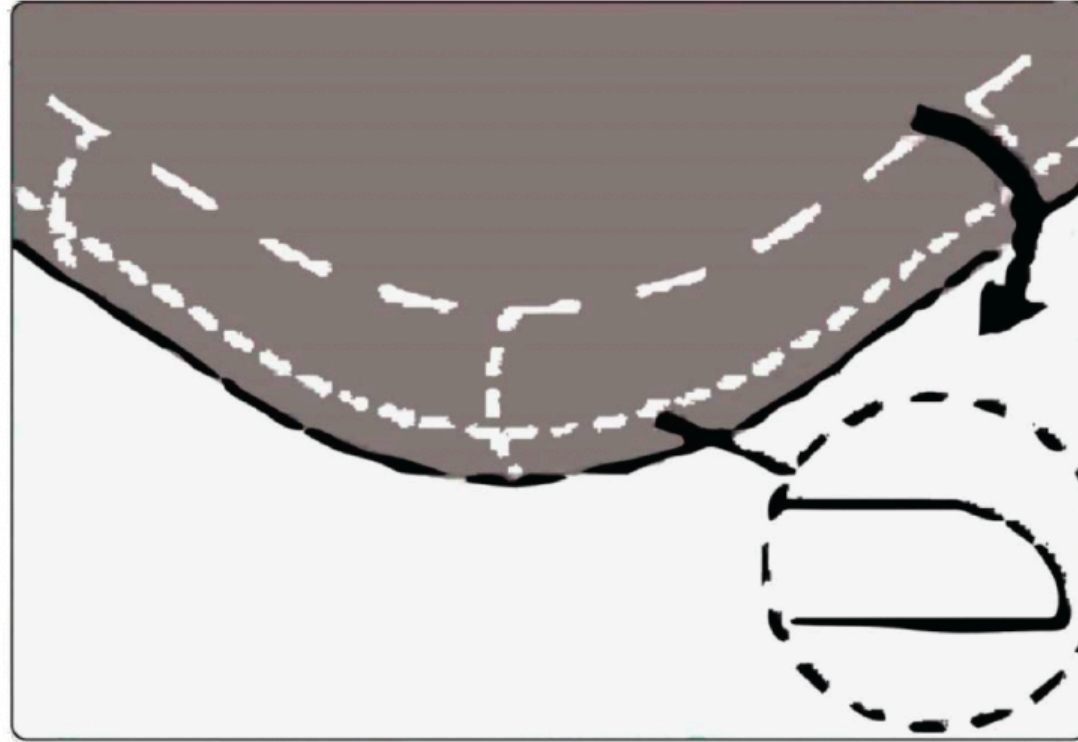

STEP 4

Apply the covering, including 2 to 5 cm of the lower area to ensure a firmer and safer covering.

STEP 5

Finish by cutting the excess INfeel sheet from the back.

Lap joint

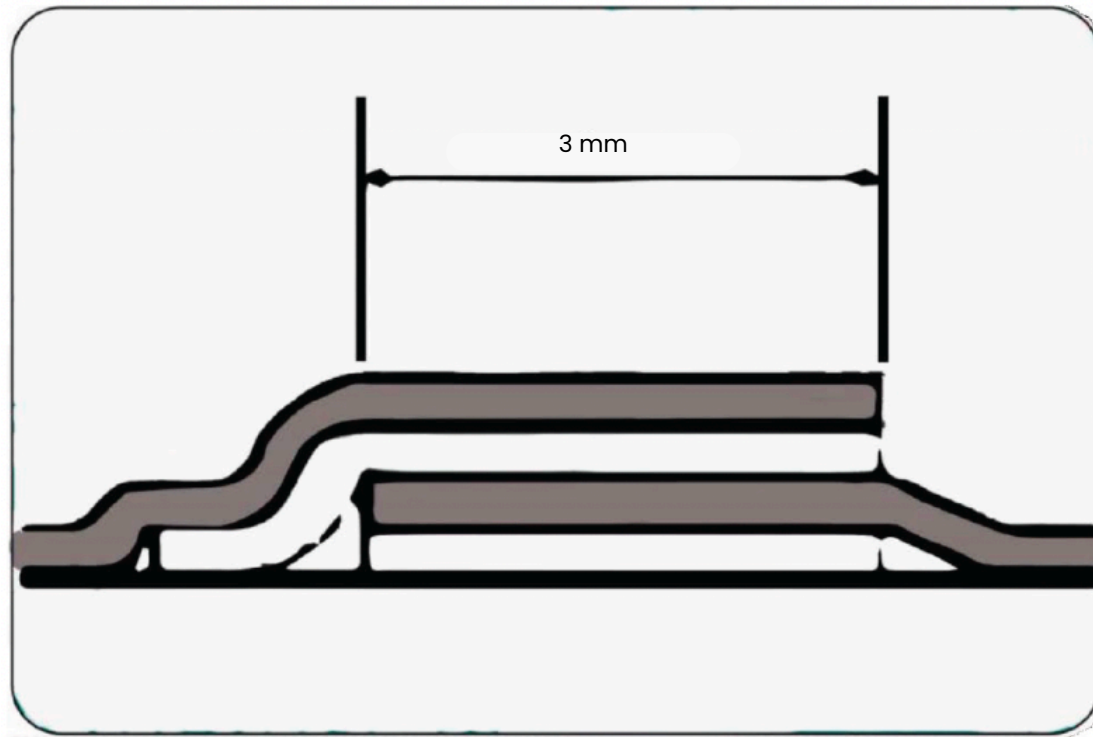

STEP 1
Once the first INfeel sheet has been placed, place the second by superimposing it on the first until the overlap is made, or about 3 mm. if there is no overlap.

Continue with the installation of the following sheets.

Outer and inner edges

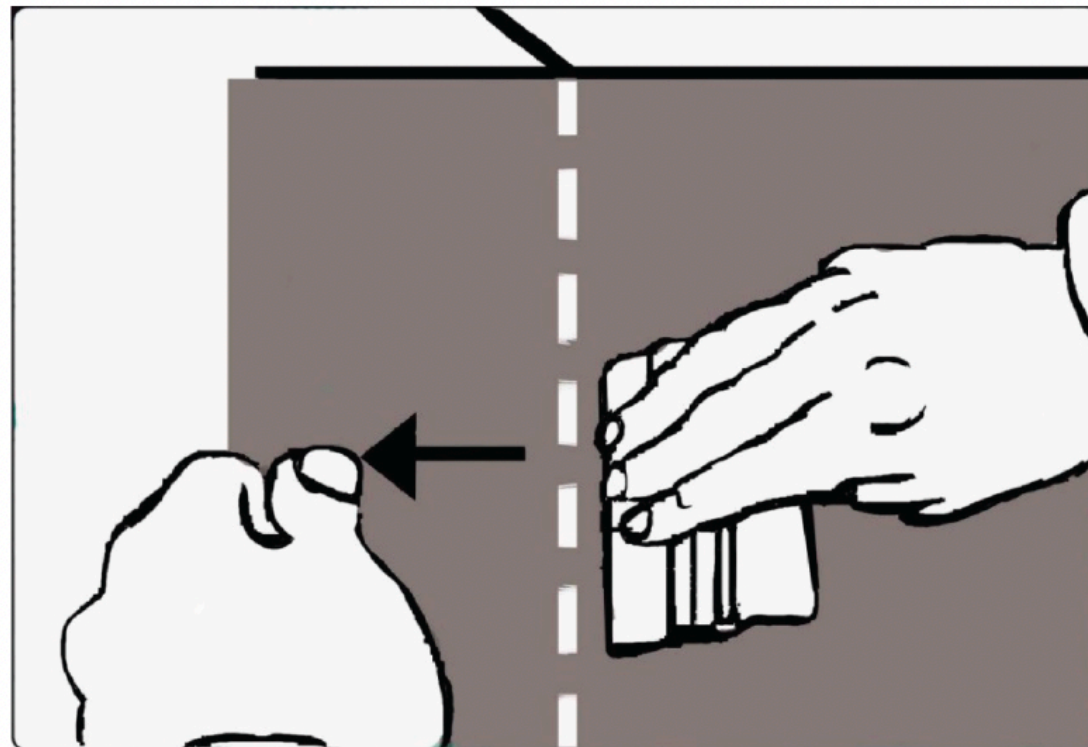

STEP 1

Cut the necessary material and remove the adhesive protector to the largest area to be covered. Place the INfeel sheet and apply pressure with the plastic spatula from the centre towards the edges.

STEP 2

Prepare the corner area by applying longitudinal pressure with the pad of the thumb. The use of gloves is recommended for this action.

Outer and inner edges

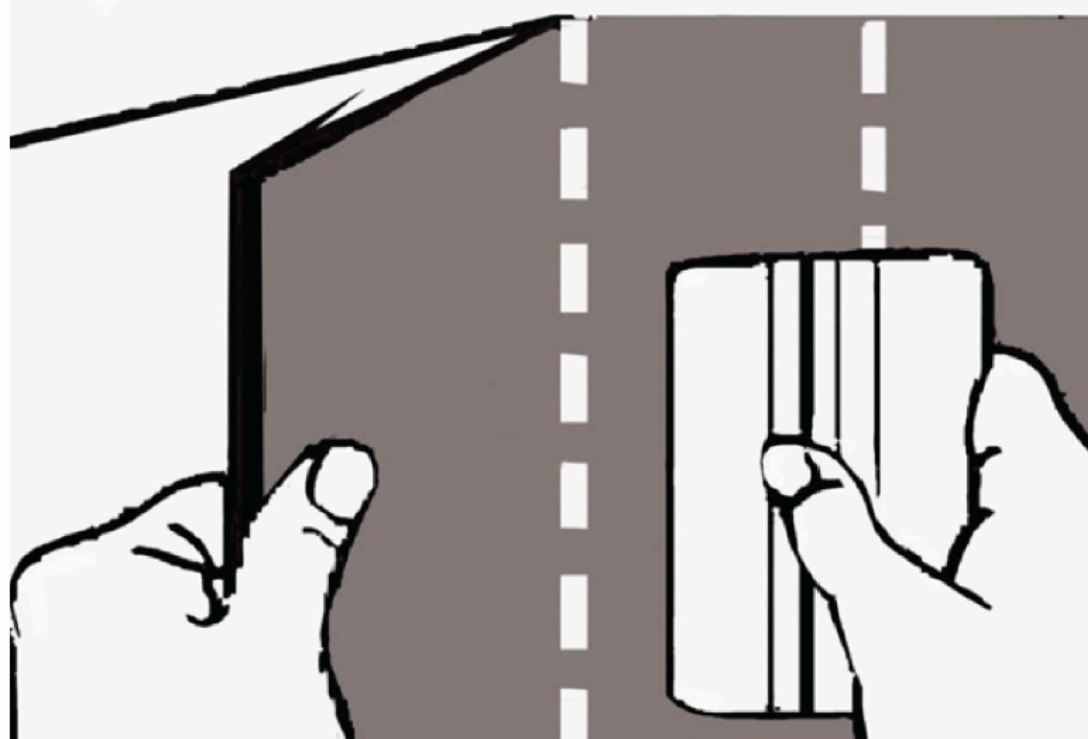

STEP 3

Gradually remove the protector from the remaining adhesive and continue the application following the instructions from step 3 for smooth surfaces. Carefully remove the excess material with a blade placed obliquely, grasping the cutter blade by hand on the other side to favor the precision of the cut.

Installation on doors



STEP 1
Start by removing the moving parts of the door such as knobs, hinges, handles, etc. Clean all areas with a damp cloth, paying special attention to areas that may have grease. Once clean, dry the entire surface.

STEP 2
It is recommended sanding the doors before the covering to ensure an optimal closure and the duration of the material after the cover.

Cleaning and maintenance



For a proper maintenance of INfeel, the most important thing is to make responsible use of the coated surface. Does not require specific maintenance.

The use of scouring pads, sandpaper or sharp elements on its surface is not recommended.

It is not necessary to use special cleaning products, normal stains come out with soap and water, difficult stains such as pen, permanent marker and so on with 96° alcohol. We can calmly apply disinfectants such as bleach or ammonia.



iNfeel coverings are not designed to be removed, and for this reason their adhesive provides a very strong bond on most of the surfaces.

If possible, we recommend applying a new iNfeel covering on top of the existing layer, instead of removing it. If this cannot be avoided, follow these recommendations:

Make lengthways cuts spaced at a distance of around 20cm, taking care not to damage the surface on which the material has been applied.

Apply heat using an air heat gun, starting at the bottom, and applying it evenly to soften the iNfeel adhesive.

Gradually remove each of the strips, starting at the bottom and using a constant zig-zag movement.

elite

Technical Assistance



ESPAÑA

Calle Zeppelin 21 – 23
Parcela 9 Nave 13
P.I. Espíritu Santo
15.650 – Cambre (A Coruña) – España
Teléfono: +34 981 276 459
Mail: info@holaelite.com

MÉXICO

Marina Puerto Cancún
BUREVA Galería · Local B-11
Blvd. Kukulcán Km. 1.5 – Puerto Juárez
– Zona Hotelera
77500 Cancún, Q.R.
Teléfono Principal: +34 981 276 459
Teléfono: +52 55 4343 8688
Mail: info@holaelite.com

REPÚBLICA DOMINICANA

Avenida Lope de Vega 29 – Novo-Centro
Tercer Nivel – Local C6
Santo Domingo Distrito Nacional
República Dominicana
Teléfono Principal: +34 981 276 459
Teléfono: +1 (809) 649 0010
Mail: info@holaelite.com

MARRUECOS

Angle Bd. Abdelmoumen
et Rue Soumia,
Immeuble Shéhérazade 3,
5° Étage · N° 22
Casablanca
Teléfono Principal: +34 981 276 459
Teléfono: +1 (809) 649 0010
Mail: info@holaelite.com

<https://holaelite.com/en>